

GRAIN LOOP

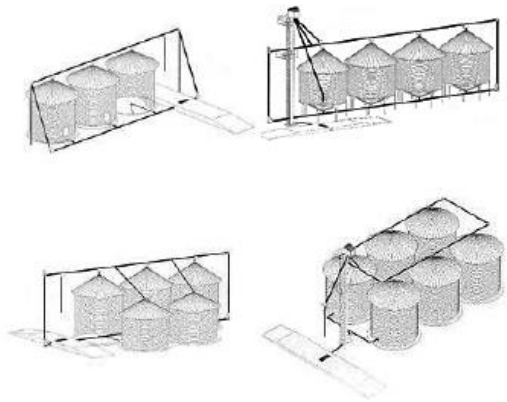



Receiving, conveying, bin unloading and loadout all in one convenient and cost effective system.

Use the **GRAIN LOOP** to update an existing site or integrate the system into a new development.

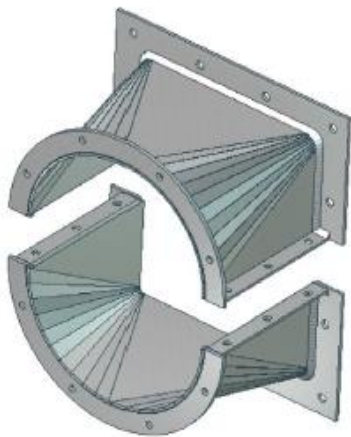

The most common wear point of the system is the transitions on the corners. Our unique split transitions allow for quick and easy replacement without having to break the chain

| Tube size | 6" (15.2cm) | 8" (20.3cm) | 10" (25.4cm) | 12" (30.48cm) |
|---|---|-----------------------|-----------------------|------------------------|
| Maximum capacity* | 2,000 BPH 51 MTPH | 4,000 BPH 102 MTPH | 6,000 BPH 152 MTPH | 10,000 BPH 254 MTPH |
| Chain travel speed | 318 fpm 97 mpm | 318 fpm 97 mpm | 336 fpm 102 mpm | 388 fpm 118 mpm |
| Head shaft RPM | 81 | 81 | 81 | 81 |
| Tube gauge | 12 GA 2.6 mm | 12 GA 2.6 mm | 12 GA 2.6 mm | 10 GA 3.43 mm |
| UHMW paddle thickness | 1/2" 12.7 mm | 1/2" 12.7 mm | 1/2" 12.7 mm | 1/2" 12.7 mm |
| Conveyor chain | 81xHH | 81xHH | 81xHH | 81xHH |
| Max. HP (kW) | 30 (22) | 60 (44) | 100 (74) | 120 (90) |
| Angle of operation | Horsepower required per foot of conveyor Kilowatt power required per meter of conveyor | | | |
| Horizontal | 0.042 0.103 | 0.076 0.186 | 0.114 0.279 | 0.178 0.435 |
| Vertical section length and angle relative to vertical line | | | | |
| 0 deg. (straight vertical) | 0.2 0.489 | 0.35 0.856 | 0.5 1.223 | 0.75 1.835 |
| 15 deg. | 0.193 0.472 | 0.338 0.827 | 0.482 1.179 | 0.724 1.771 |
| 30 deg. | 0.173 0.423 | 0.3 0.734 | 0.433 1.06 | 0.65 1.59 |
| 45 deg. | 0.141 0.345 | 0.247 0.604 | 0.353 0.863 | 0.53 1.296 |

* Note that capacities are estimates only. Capacities based on 45 lb/ft² dry shelled corn.

FEATURES

- Gentle grain handling
- High quality roller chain
- Galvanized construction to ensure a long service life
- Complete line of accessory equipment:
 - Intermediate discharge gates
 - Transitions
 - Catwalks and support towers
 - Receiving hoppers and bin wells